

Załącznik nr 1.1
do Specyfikacji Istotnych
Warunków Zamówienia

Schematy stacji linii metra M1
z zaznaczeniem umiejscowienia
tablic informacyjnych

A-1 „Kabaty”

0

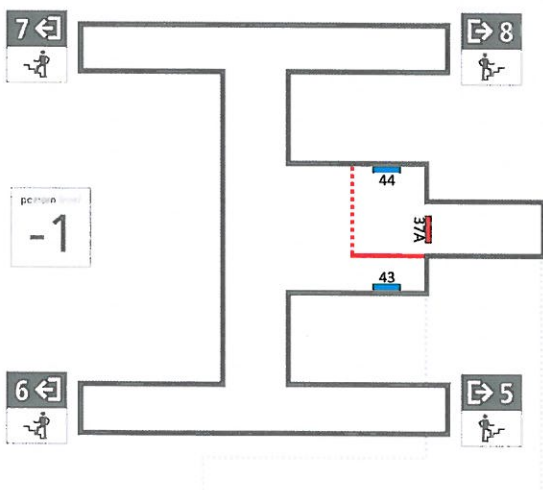

-1



-2

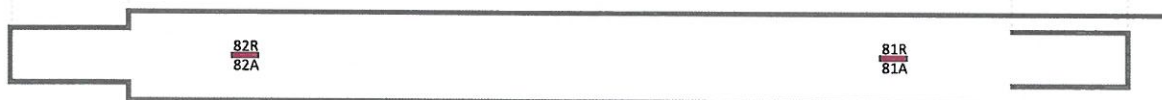

← Młociny

Kabaty →

A-2 „Natolin”

0

7

8

-1

44

37A

43

6

5

-2

82R
82A

81R
81A

← Młociny

Kabaty →

1

2

41

36A

42

4

3

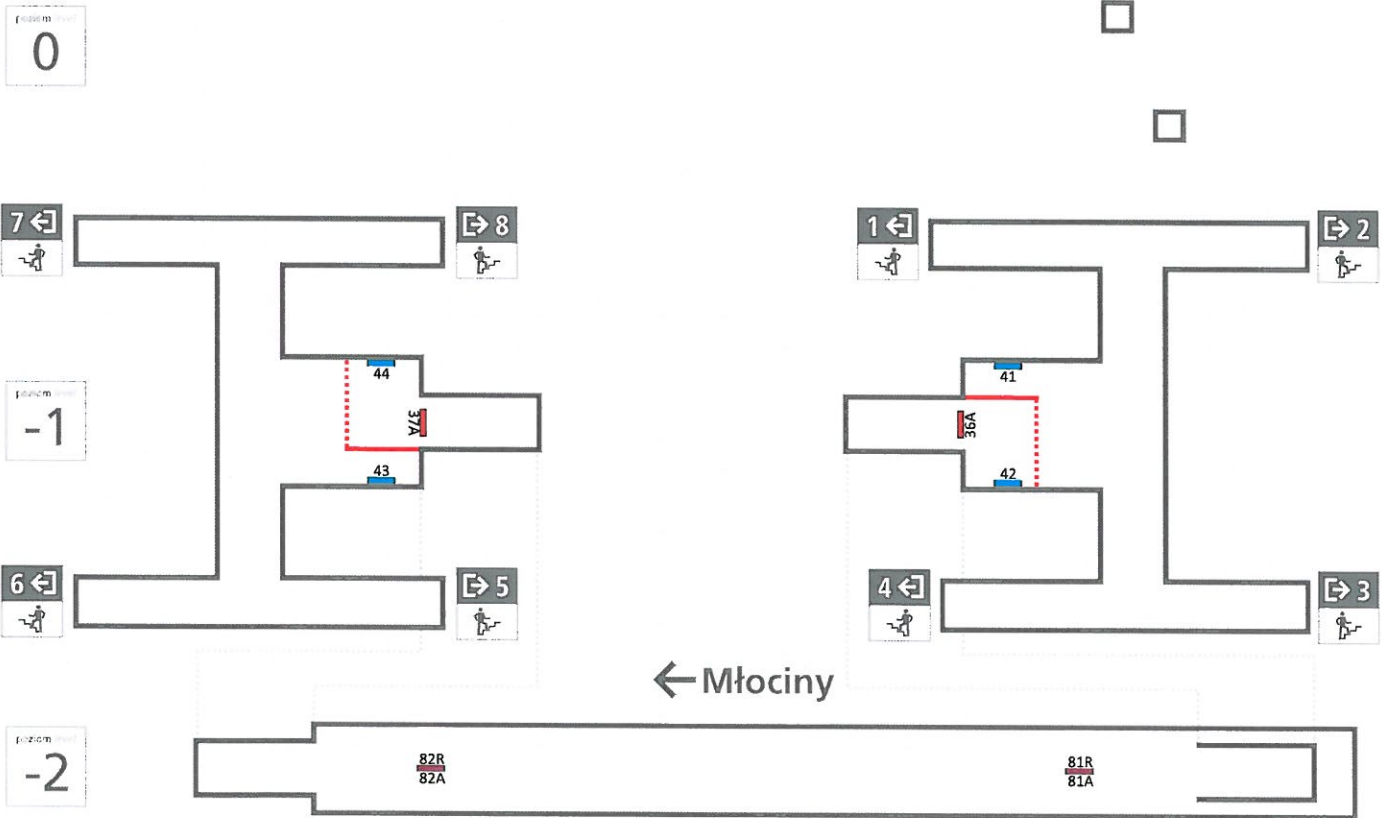

A-3 „Imielin”

0

5 ←

→ 6

-1

4 ←

→ 3

-2

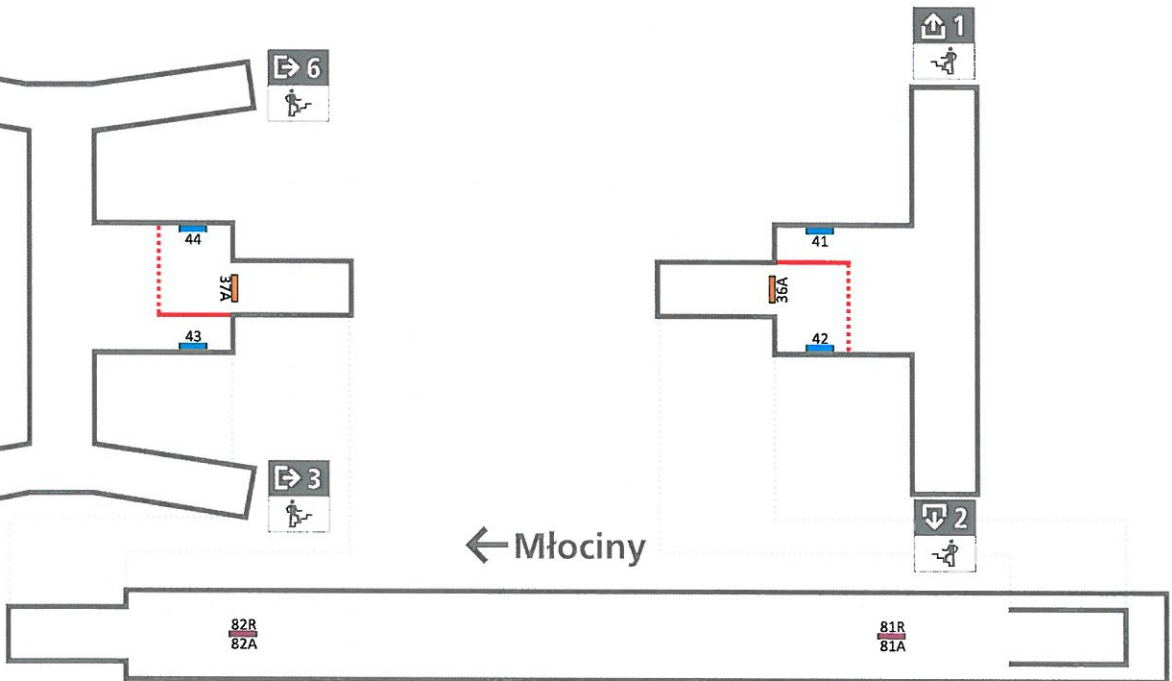

A-4 „Stokłosy”

poziom 0

5 ↩
↯

poziom -1

4 ↩
↯

poziom -2

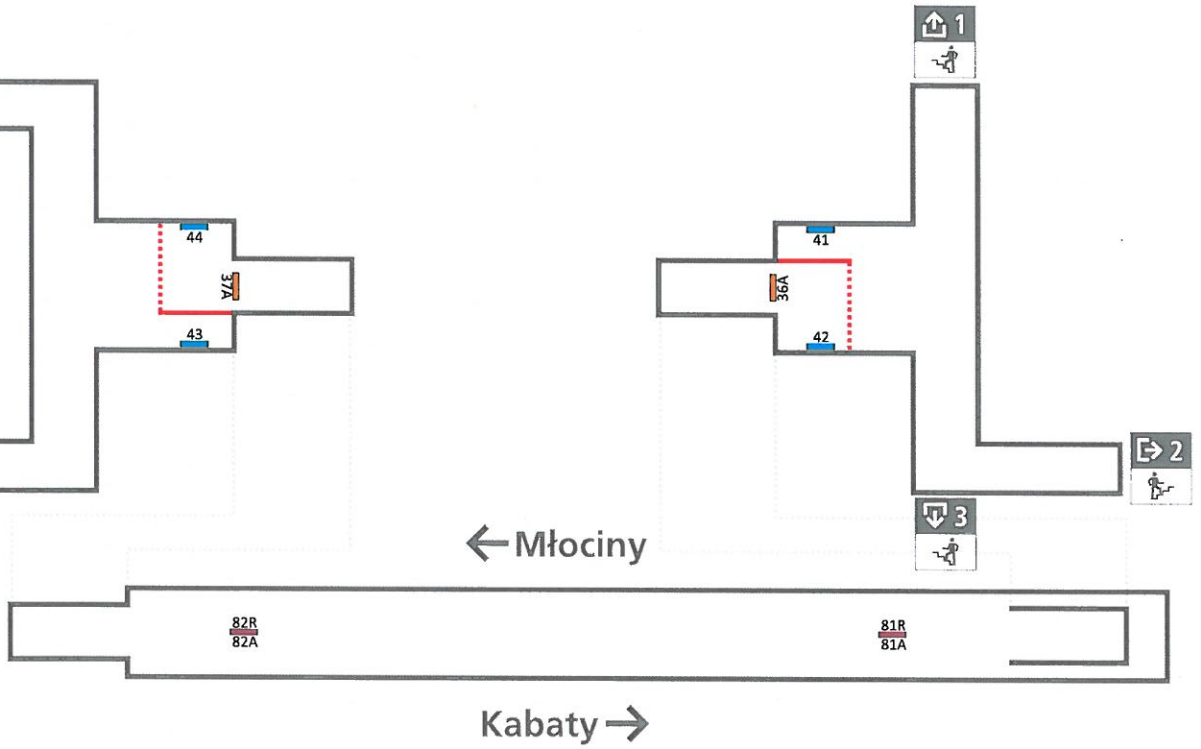

A-5 „Ursynów”

poziom
0

poziom
-1

poziom
-2

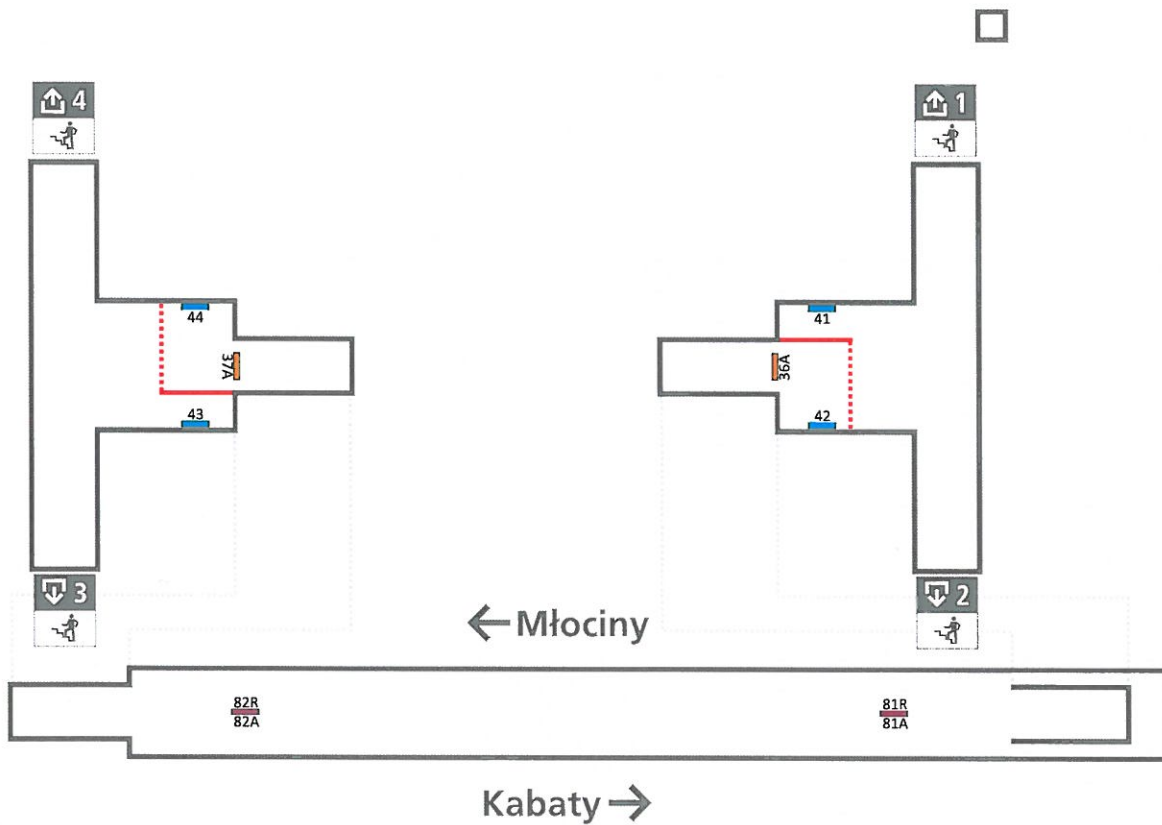

A-6 „Służew”

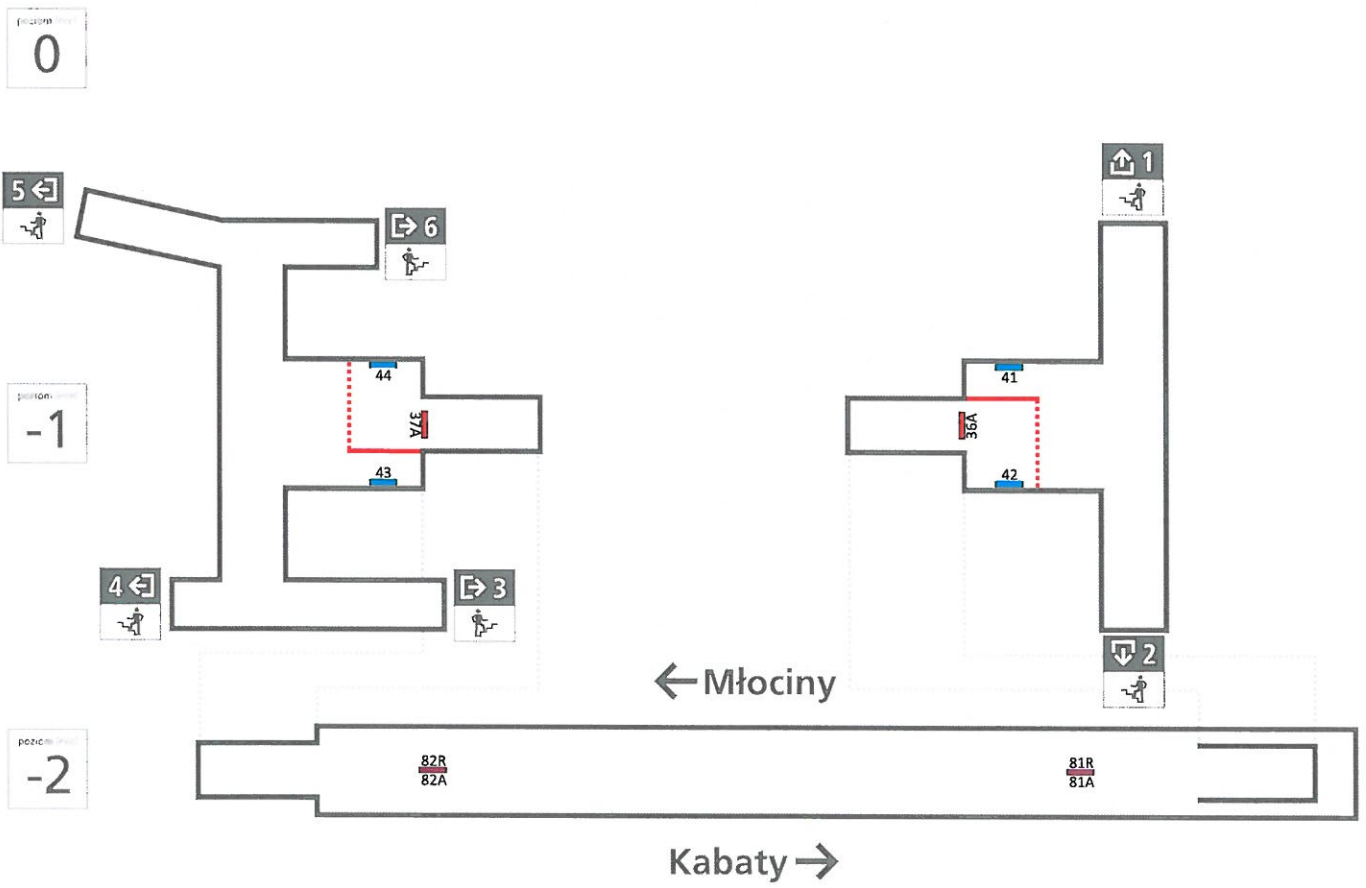

A-7 „Wilanowska”

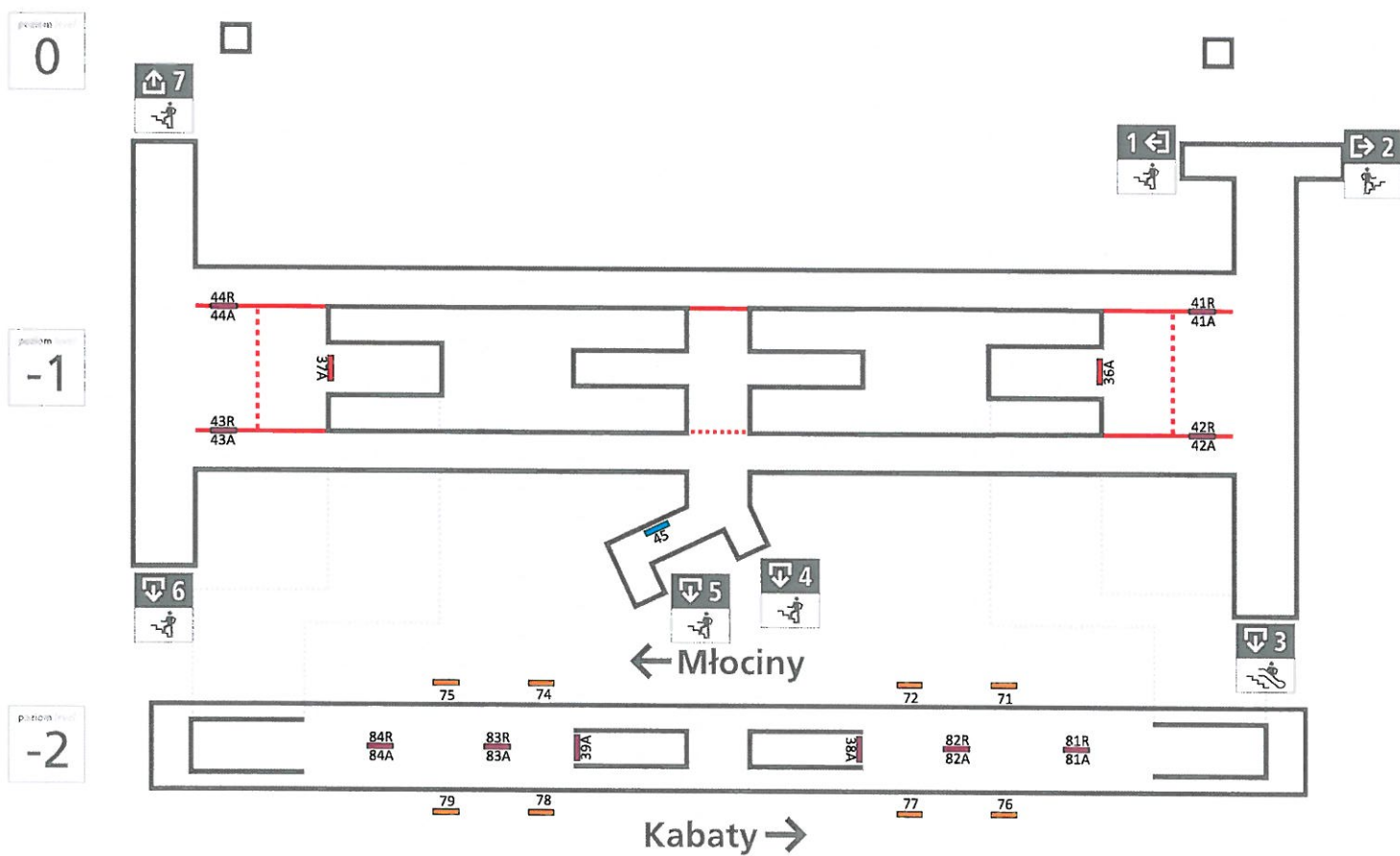

A-8 „Wierzbno”

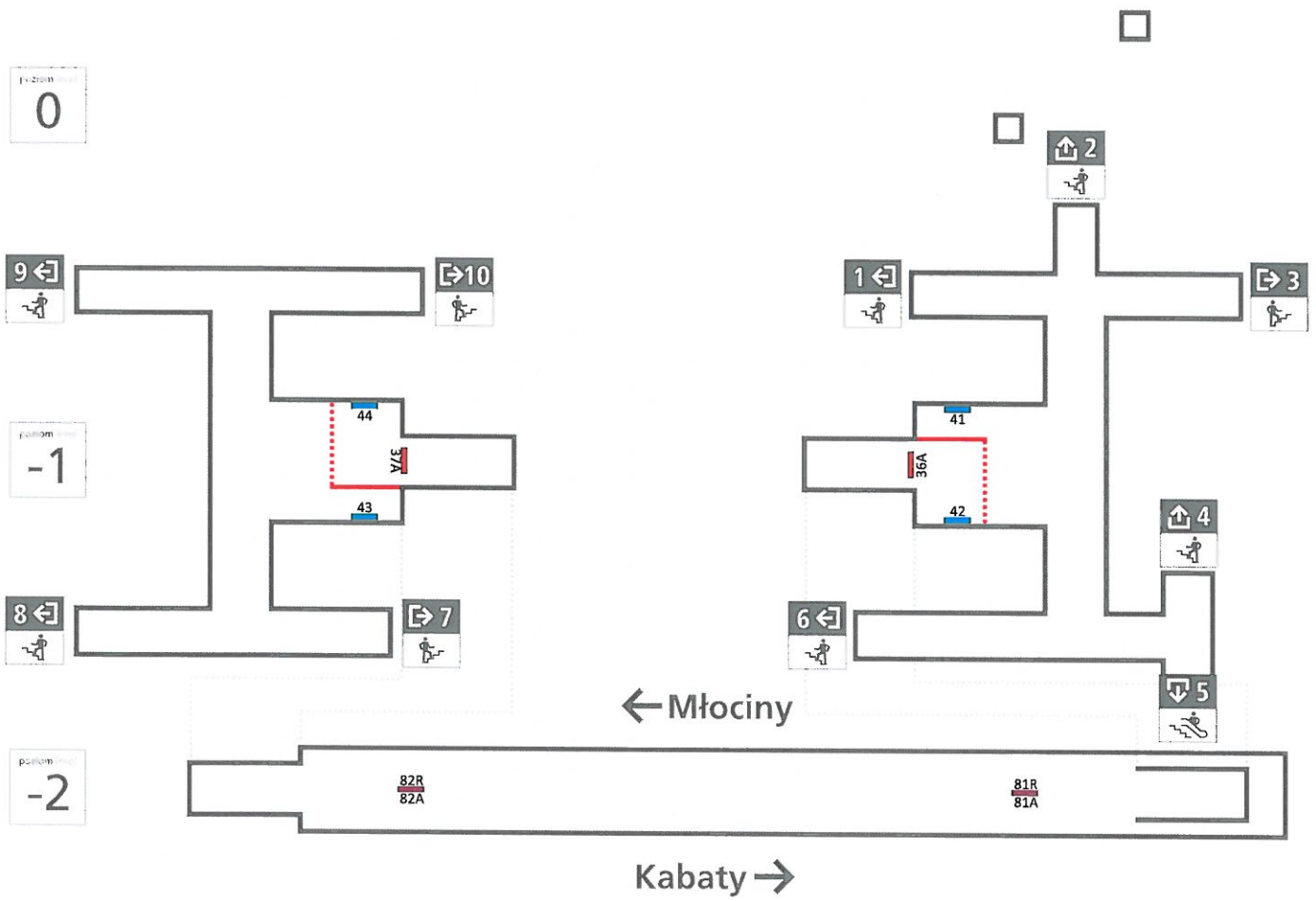

A-9 „Raclawicka”

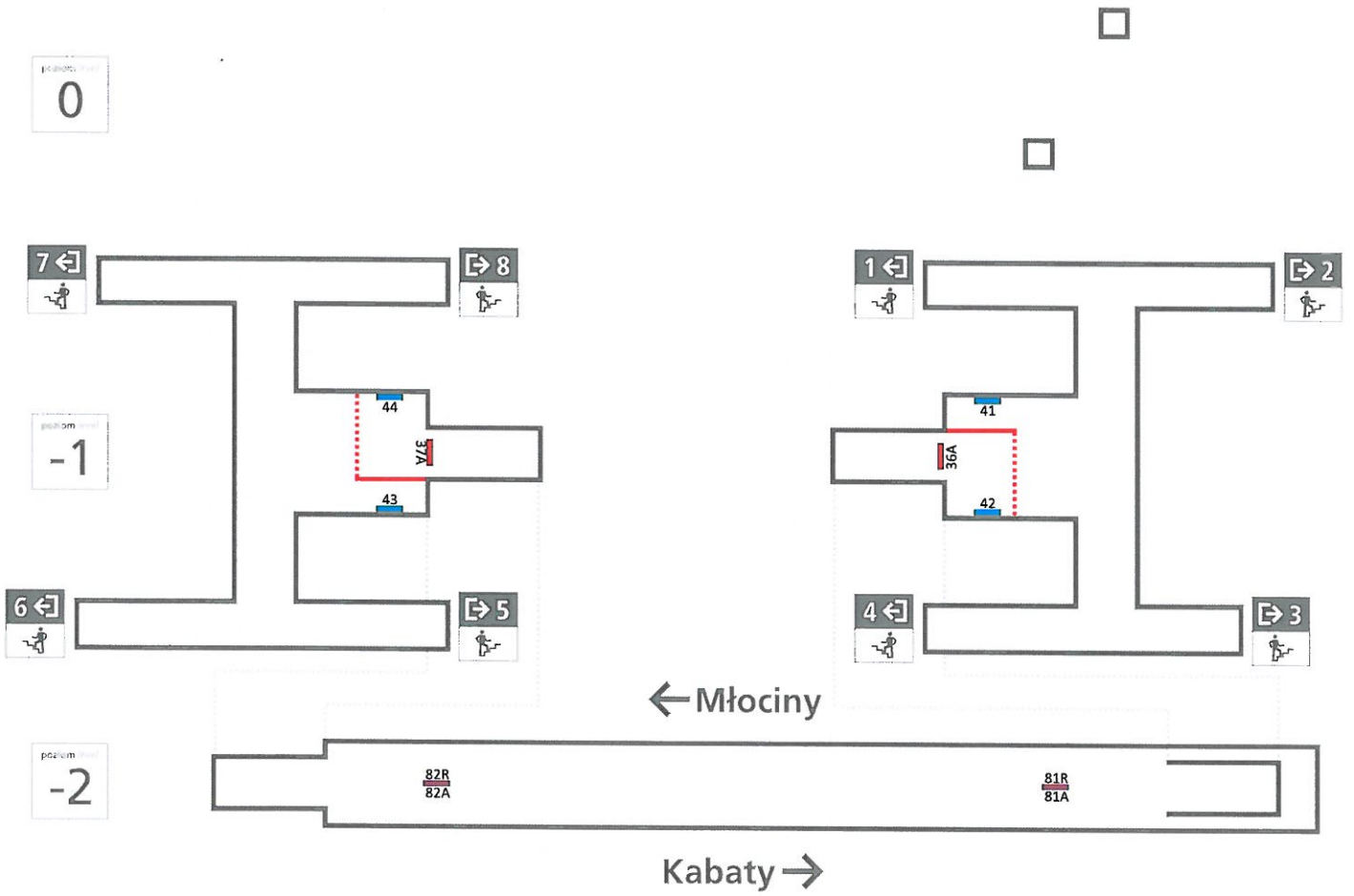

A-10 „Pole Mokotowskie”

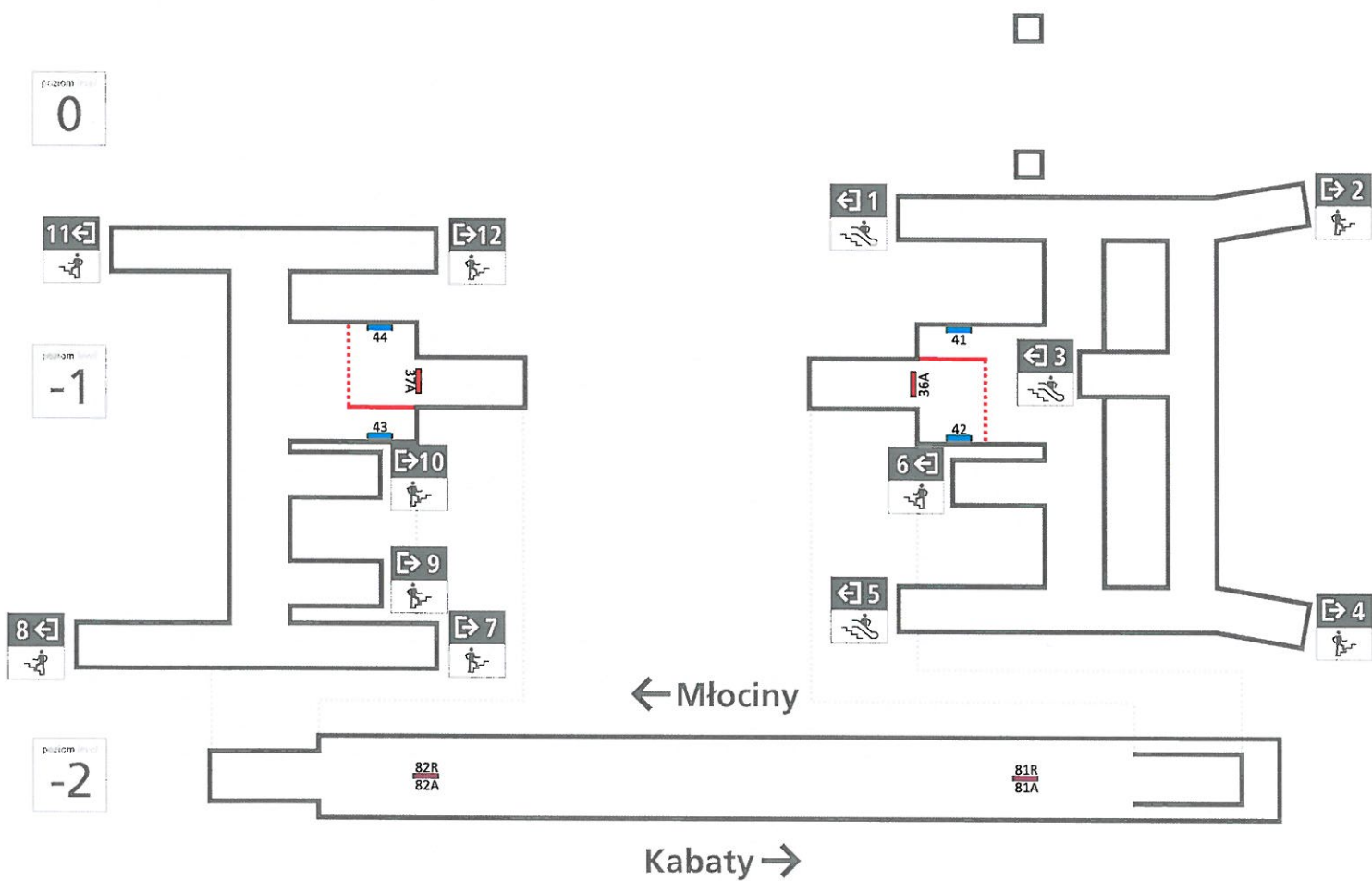

A-11 „Politechnika”

0

6

-1

5

-2

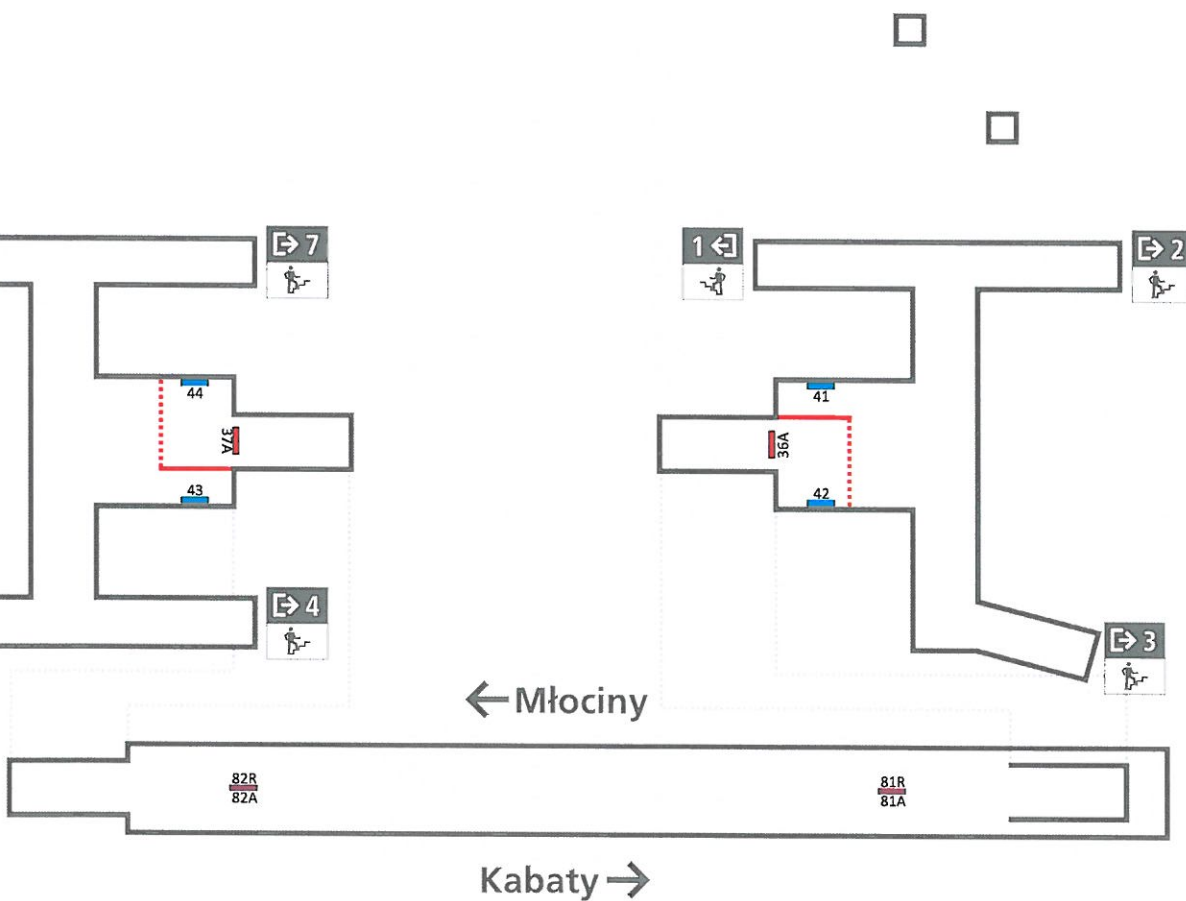

A-13 „Centrum”

0



-1

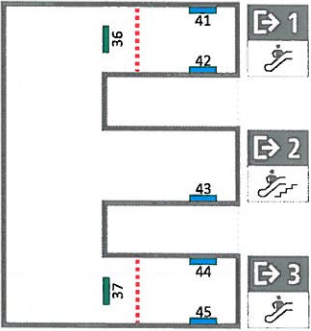

-2

38

46

48

66



-3

82

81

← Młociny

Kabaty →

83

84



A-14 „Świętokrzyska”

0

-1

-2

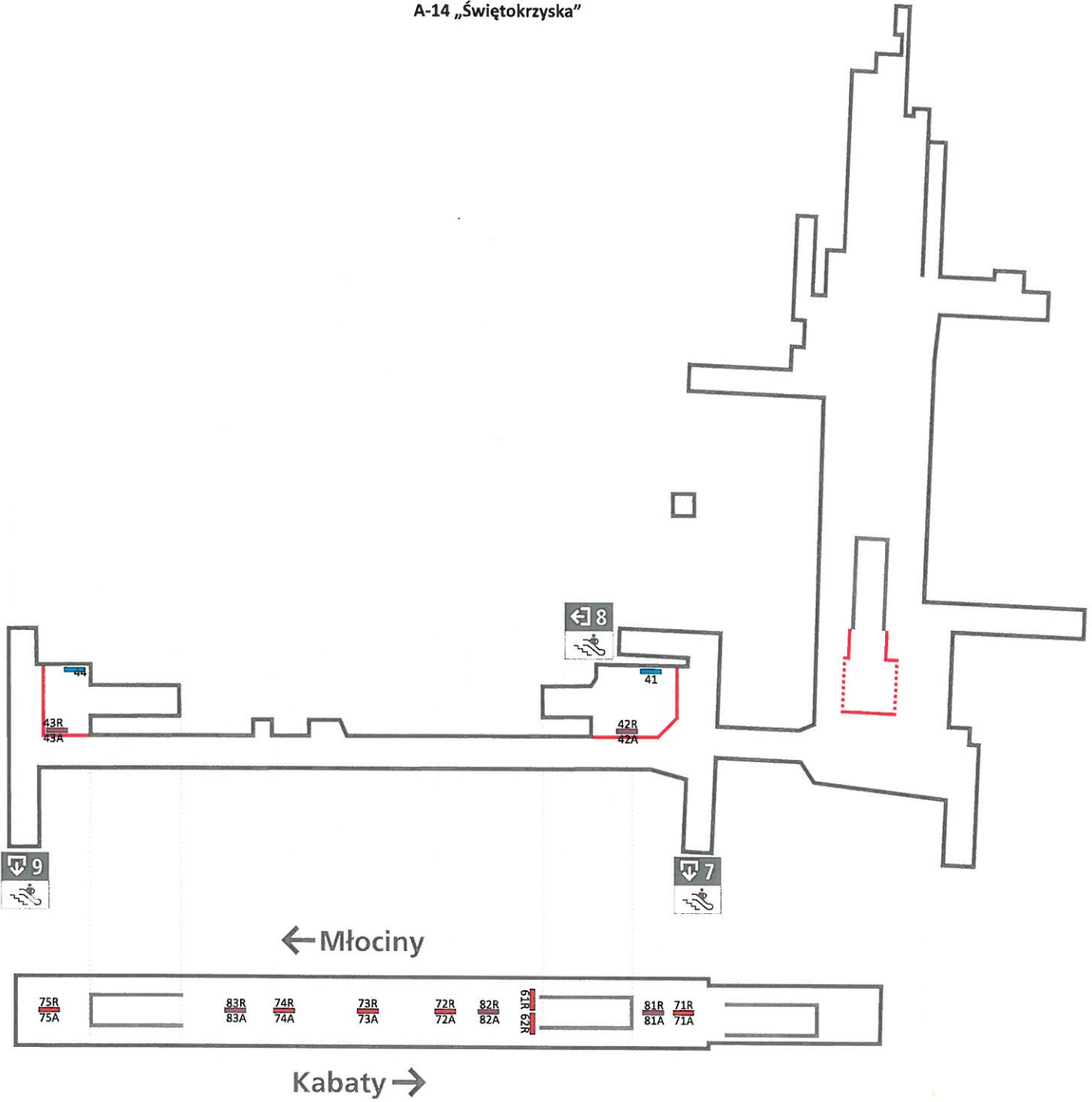

A-15 „Ratusz Arsenal”

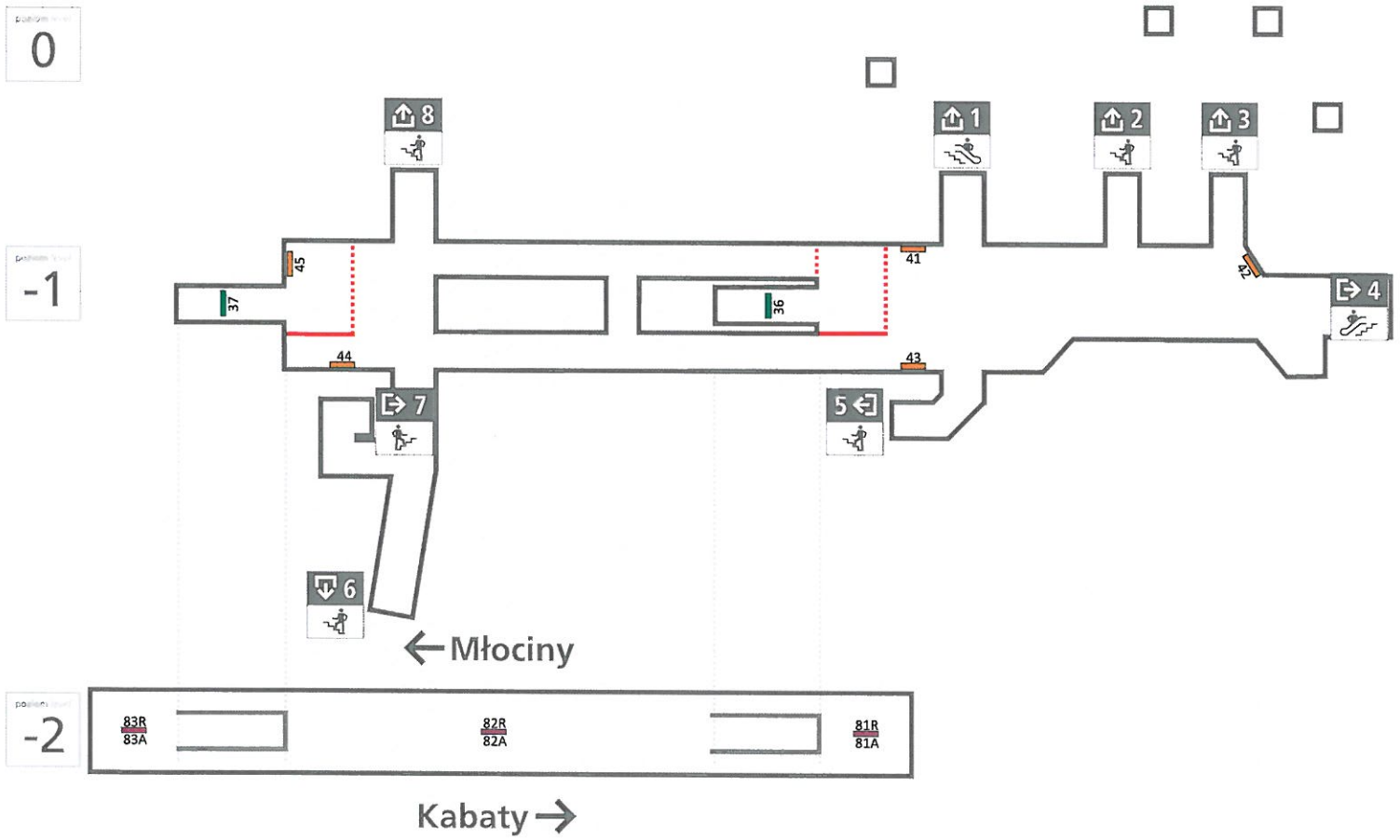

A-17 „Dworzec Gdański”

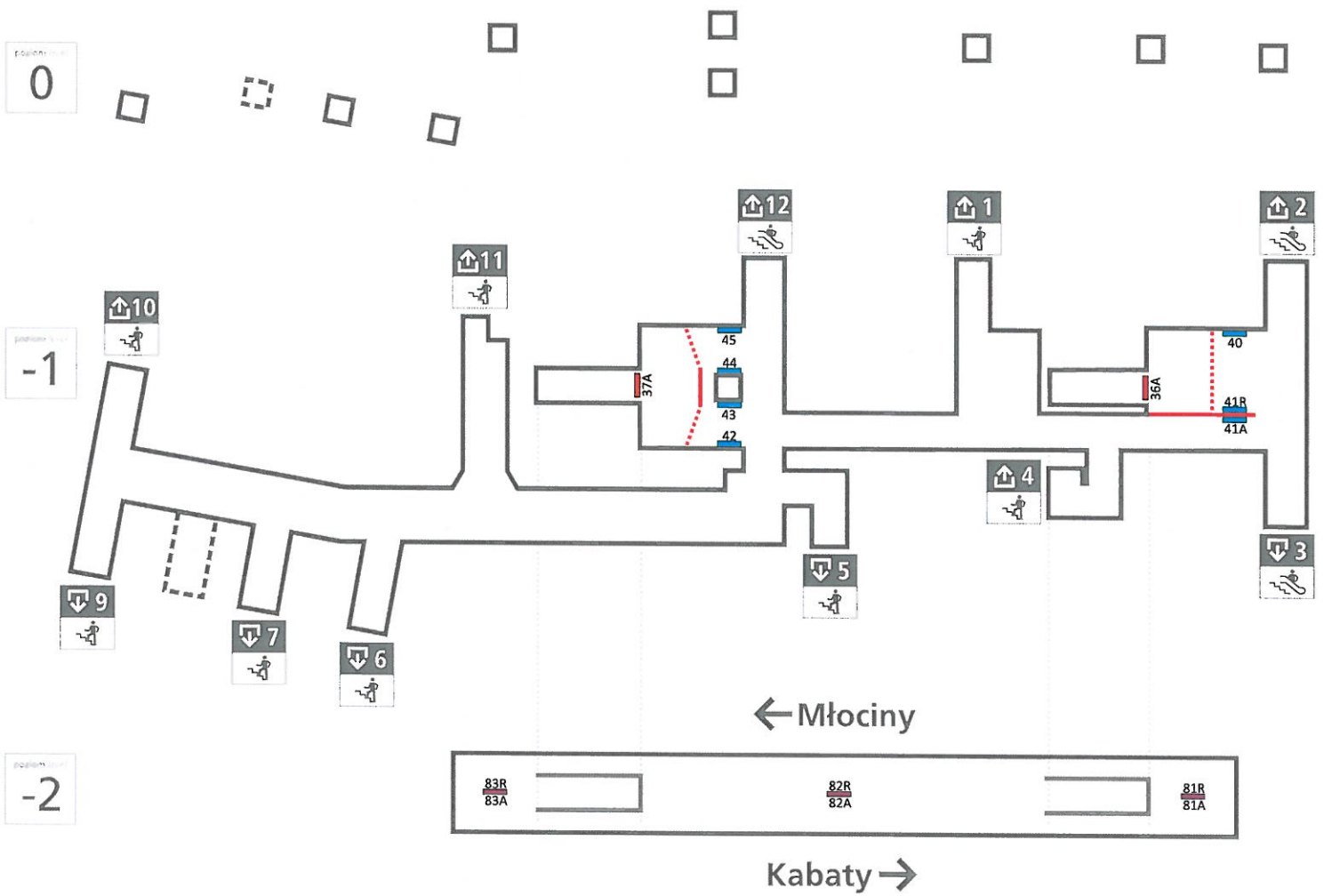

A-18 „Plac Wilsona”

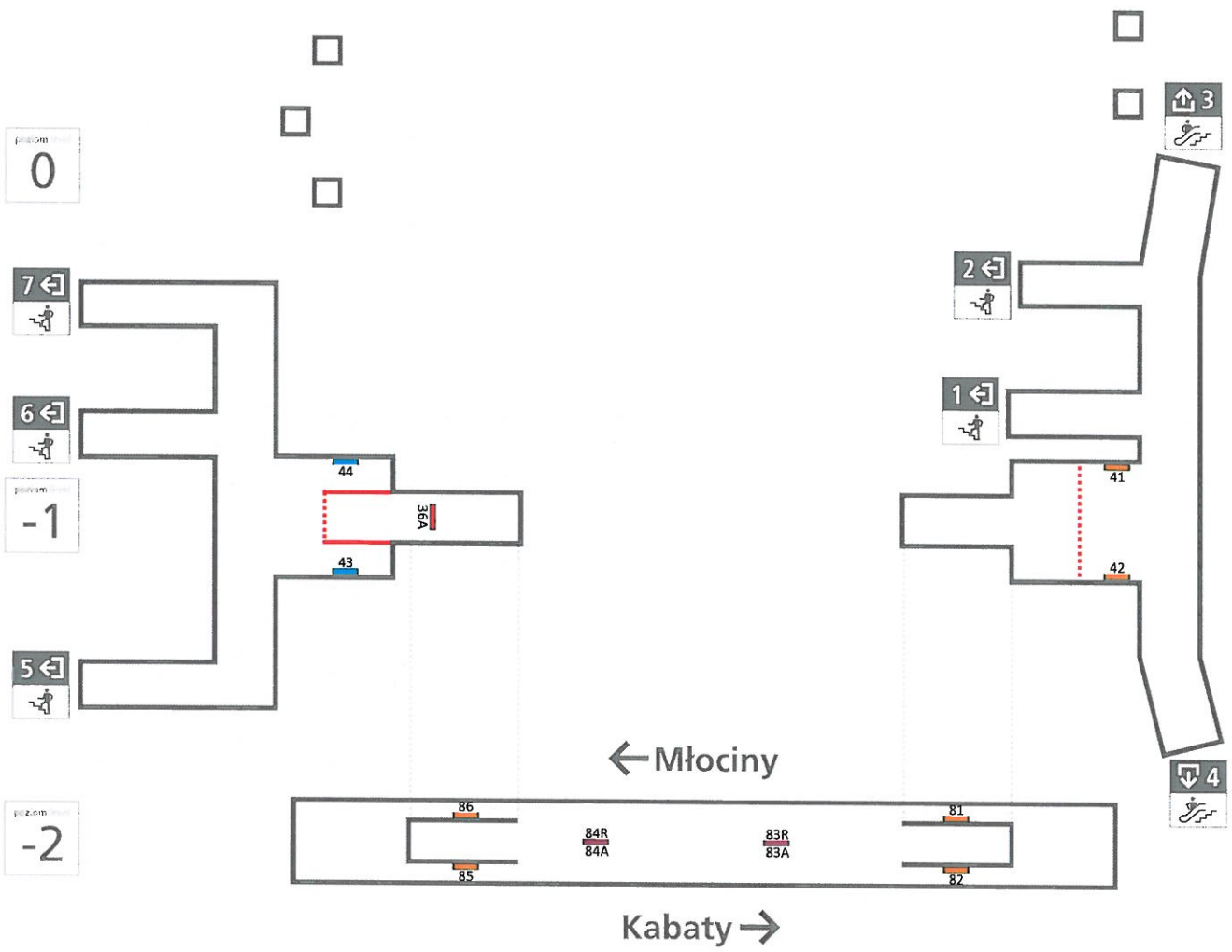

poziom
0

A-19 „Marymont”

poziom
-1

poziom
-2

poziom
-3

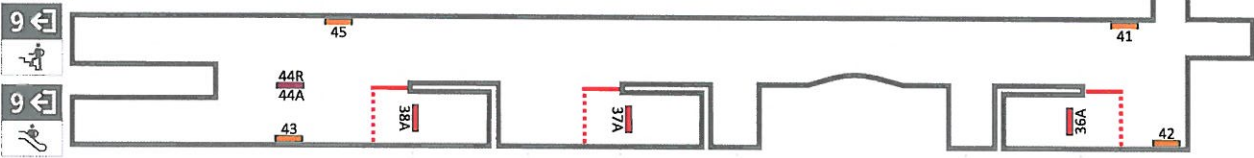
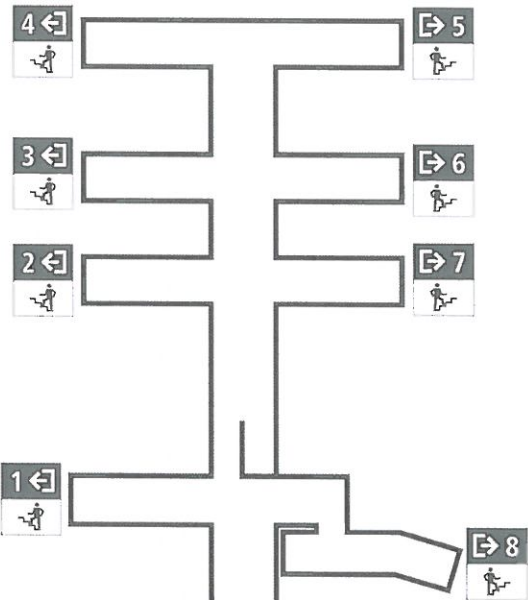

← Młociny

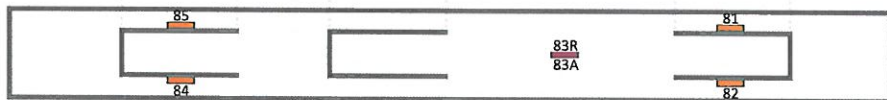

Kabaty →

A-20 „Stodowiec”

pozioma
0

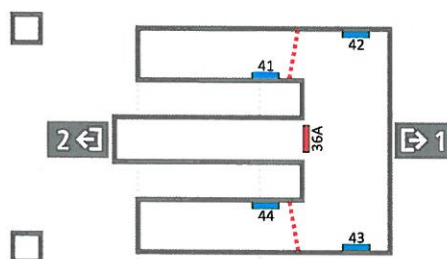
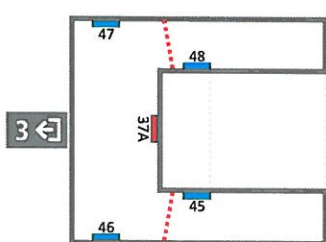

pozioma
-1

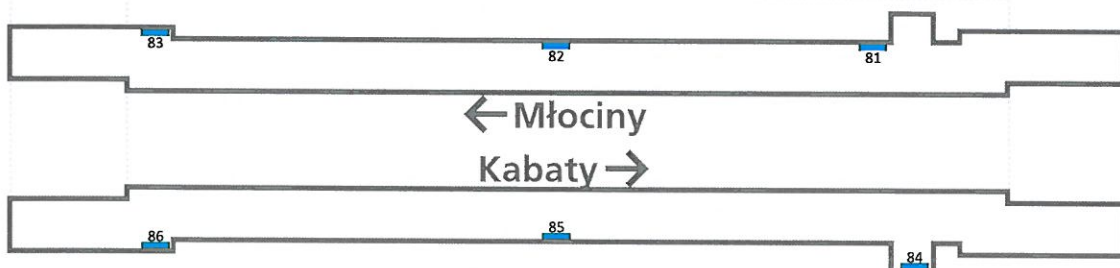

A-21 „Stare Bielany”

poziom 0

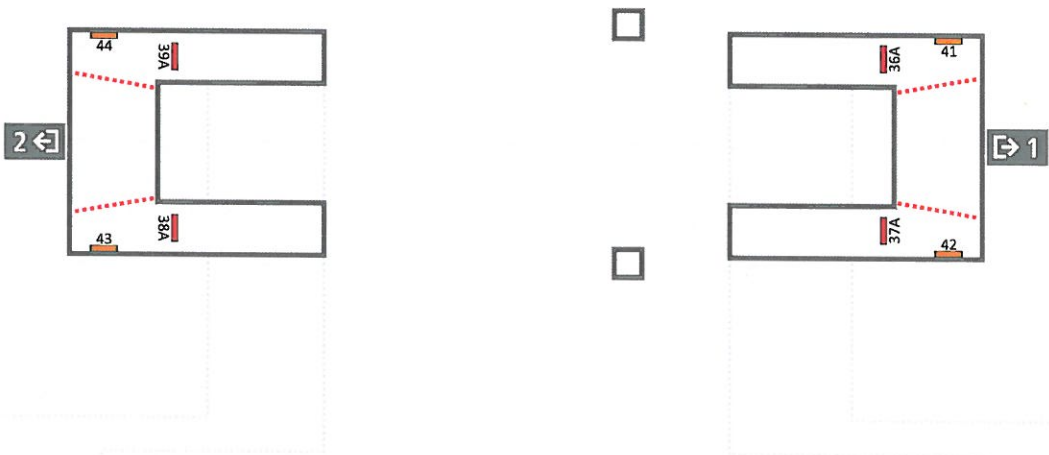

poziom -1

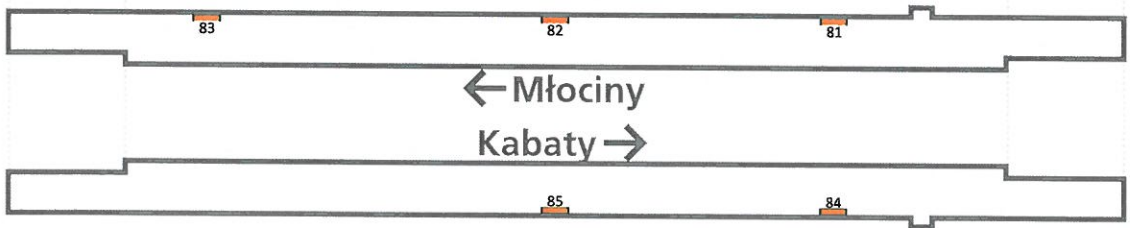

A-22 „Wawrzyszew”

poziom
0

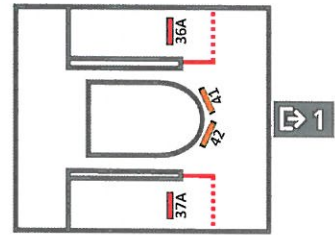
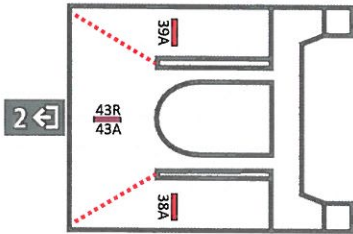

poziom
-1

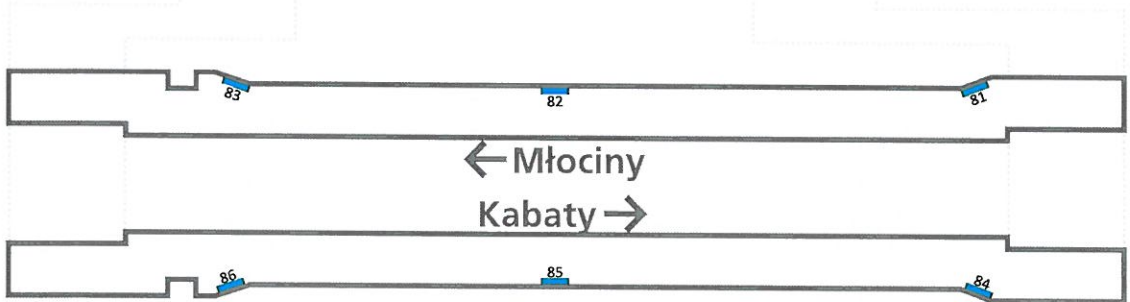





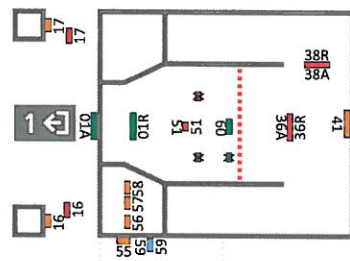
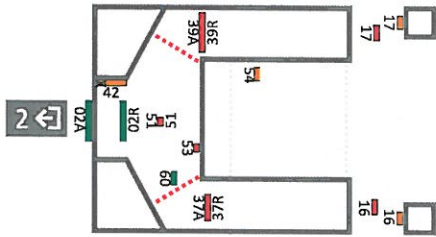

A-23 „Młociny”

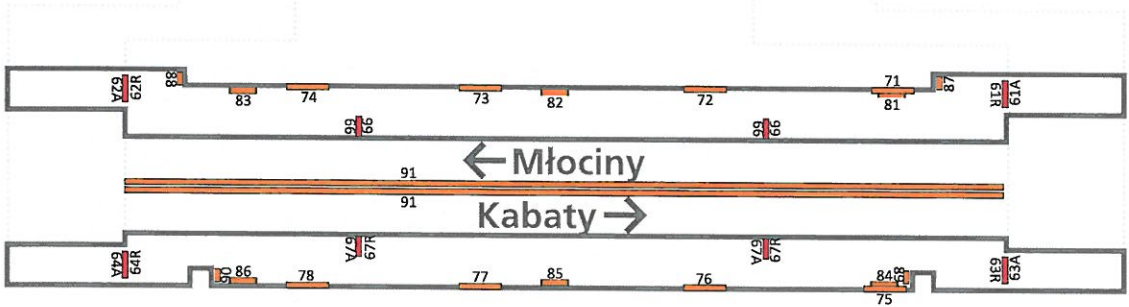
piizemie 0



piizemie -1



-  tablica wisząca dwustronna (wysokość zamontowania ok. 2,4÷4,0 m)
-  tablica wisząca jednostronna (wysokość zamontowania ok. 2,4÷4,0 m)
-  tablica stojąca dwustronna
-  tablica stojąca jednostronna
-  tablica ścienna jednostronna (wysokość zamontowania ok. 2,0÷4,0 m)
-  tablica ścienna dwustronna (wysokość zamontowania ok. 2,0÷4,0 m)